

Track Profile System



The Track Profile System is a solution for constructing heavy duty transport equipment. It consists of a special Track Profile and guided Rollers.

Track Profile 8 80x40 is used as a guide rail for customised carriages equipped with Roller Units. Rollers D60 PU are ball-bearing mounted and are fitted with wear-resistant polyurethane tyres to ensure smooth and quiet running.

The pre-assembled Roller Units D60 PU can be fitted to carriers or frames constructed from aluminium profiles, preferably Profile 8.



The freely selectable support widths and axle distances of the carriage construction enable the guide to be constructed for the given application. The result is a system for manual or automatic transportation of even heavy products that is particularly robust and insensitive to ambient factors such as dust and knocks.

Track Profiles and Roller Units are also ideal for constructing overhead suspension units. An additional guide roller on the base plate guides Roller Unit D60 PU laterally in the Track Profile.

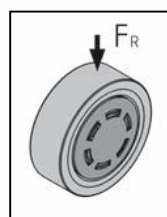

$$F_R = 800 \text{ N}$$

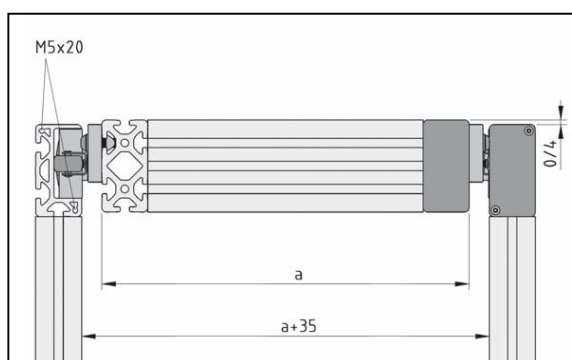

Connection dimensions and structure of a slide construction with Roller Unit D60 PU and Track Profile 8 80x40.

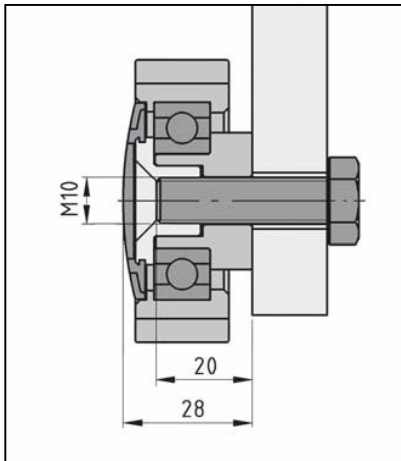

Rollers D60 PU can also be used as universal guide and support elements for pull-outs, as guide elements for sliding doors, and for all linear movements where flexibility and high load-bearing capacity are particularly important.

They can be screwed from the outside (Countersunk Screw DIN 7981-M8) or inside (via the M10 internal thread) as required.

Roller D60 must always be fitted with the circlip facing outwards.

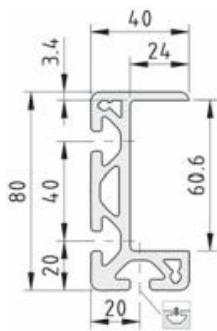

Track Profile 8 80x40

0.0.606.69

Aluminium, anodized

m = 2.84kg/m

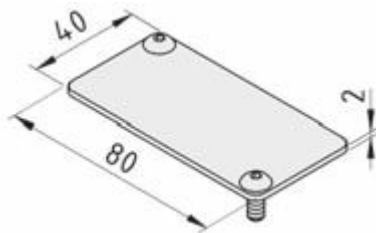

Cap Set, Track Profile 8 80x40

0.0.608.95

4 Caps, St, black

8 Button-head screws M5x16, bright zinc-plated

m = 49.3g

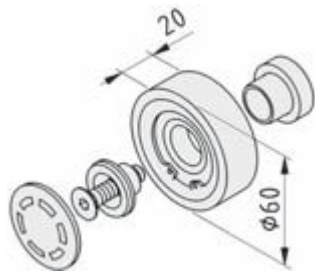

Roller D60 PU

0.0.608.94

Roller D60, St

Tyre PU, 92 Sh A, yellow

Bearing sleeve, St, bright zinc-plated

Axial securing device, St, bright zinc-plated

Cap, POM, black

Countersunk Screw DIN 7981 M8x35

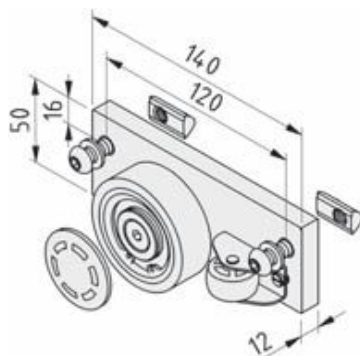

Roller Unit D60 PU

0.0.606.90

Connecting Plate, Aluminium, anodized

Roller D60 PU

Guide roller with compression spring and fastening material

2 Button-Head Screws ISO 7380-M8x25

2 washers DIN 433-8,4, St, bright zinc-plated

2 T-Slot Nuts V 8 St M8, bright zinc-plated